



GOTHIC ARCHITECTURE

Prepared By : Karzan Othman Ahmed

What is Gothic Architecture ?

Gothic Architecture : is an architectural style that flourished in Europe during the late Middle Ages . It evolved from Romanesque Architecture and was succeeded by Renaissance Architecture.



Middle Ages

Middle Ages, the period in European history from the **collapse of Roman civilization** in the **5th century (476)** to the period of the **Renaissance** (variously interpreted as beginning in the 13th, 14th, or **15th century**, depending on the region of Europe and other factors)

Dark Ages

Dark Ages or **Early Middle Ages**, the early **medieval period** of western **European** history—specifically, the time **(476–800 ce)** when there was no Roman (or Holy Roman) emperor in the West.

History Of Gothic Architecture (1050-1530)

- Gothic is the final phase of the medieval architecture.
- It originated in France.
- Until the beginning of 13th century, French influence was paramount.
- It prevailed in northern Europe for nearly 300 years

Gothic period can be divided into three phases:

- * **Early Gothic : c.1130–c.1240 (Leon cathedral)**
- * **High Gothic (Classical Gothic) : c.1240–c.1350 (cologne cathedral)**
- * **Late Gothic : C.1350–c.1500**

Gothic period can be divided into three phases:

Early Gothic : c.1130–c.1240 (Leon cathedral)



Gothic period can be divided into three phases:

High Gothic (Classical Gothic) : c.1240–c.1350 (cologne cathedral)

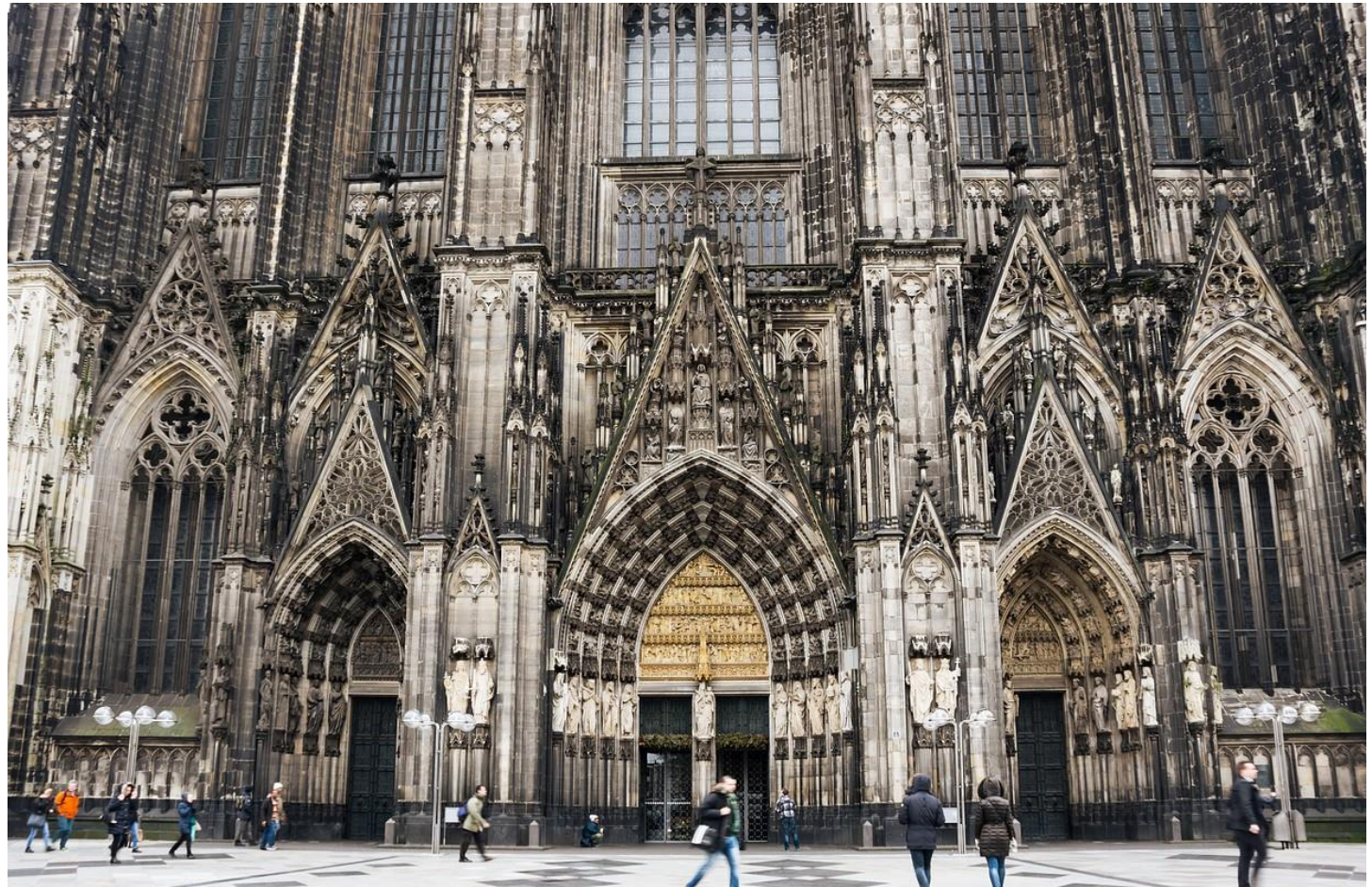

Characteristics of Gothic Architecture

- **Pointed Arch**
- **Rib Vaults**
- **The Flying Buttress**
- **Stained Glass Windows**
- **Gargoyles**

Pointed Arch :

- **The Gothic style brought innovative new construction techniques that allowed churches and other buildings to reach great heights.**
 - **One important innovation was the use of pointed arches.**
 - **Earlier Romanesque churches had pointed arches but builders didn't capitalize on the shape.**
 - **During the Gothic era, builders discovered that pointed arches would give structures amazing strength and stability**

Pointed Arch :

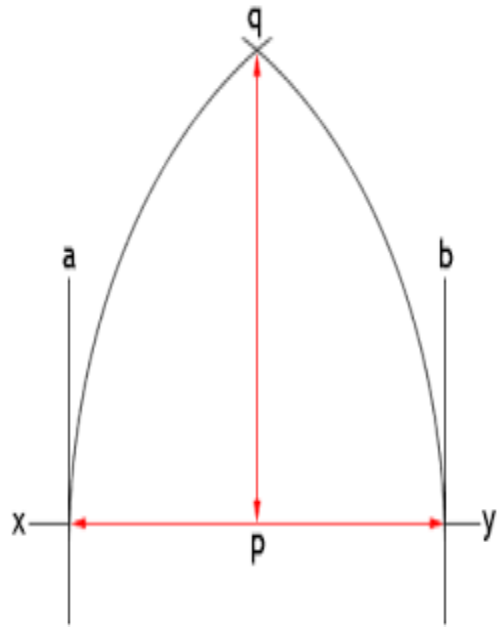

Rib Vaults

- **Organic metaphor alluding to the role of ribs in anatomy as the body's skeletal structure supporting tissues.**
- **Arches, usually three pairs per rectangular bay, running diagonally**
- **Cross ribs act together with outer frame to create a complete armature of arches along the edges and main folds of the vault**

Rib Vaults

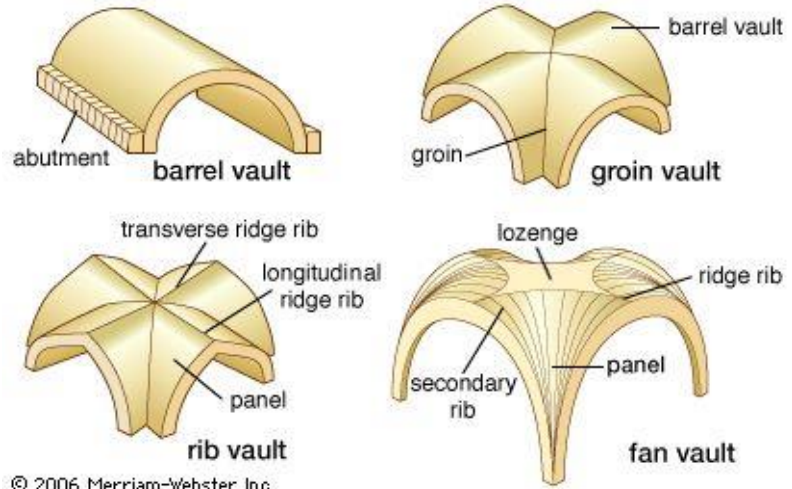

© 2006 Merriam-Webster, Inc.

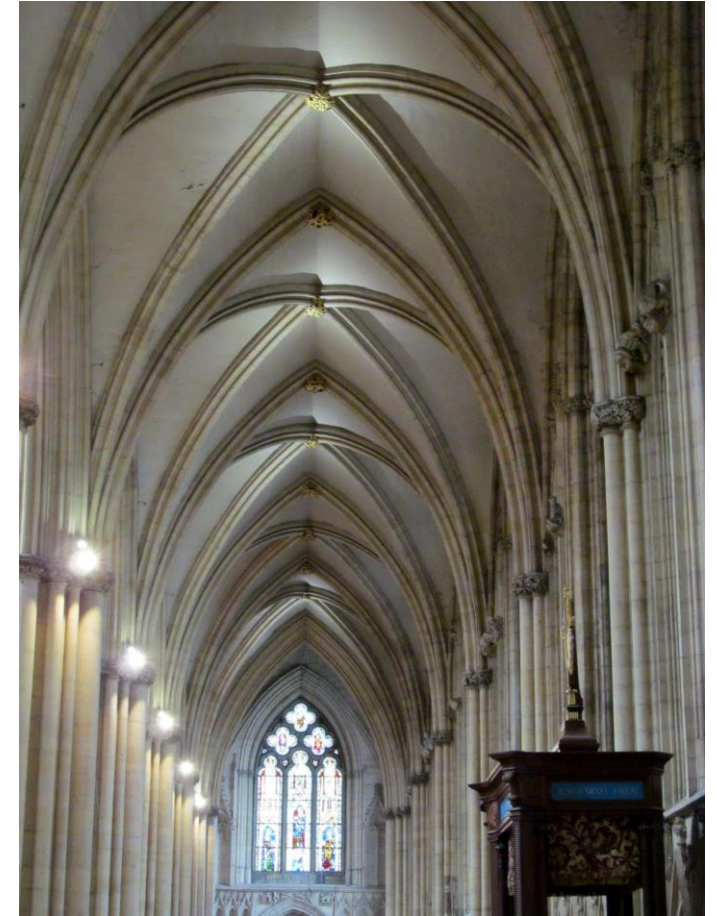

The Flying Buttress

- In order to prevent the outward collapse of the arches, Gothic architects began using a revolutionary "flying buttress" system.

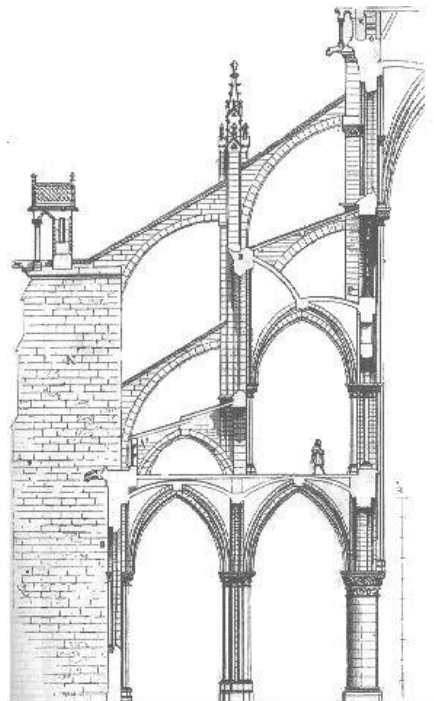

Stained Glass Windows

- Since the walls themselves were no longer the primary supports, Gothic buildings could include large areas of glass.
 - Huge stained glass windows and a profusion of smaller windows created the effect of lightness and space.

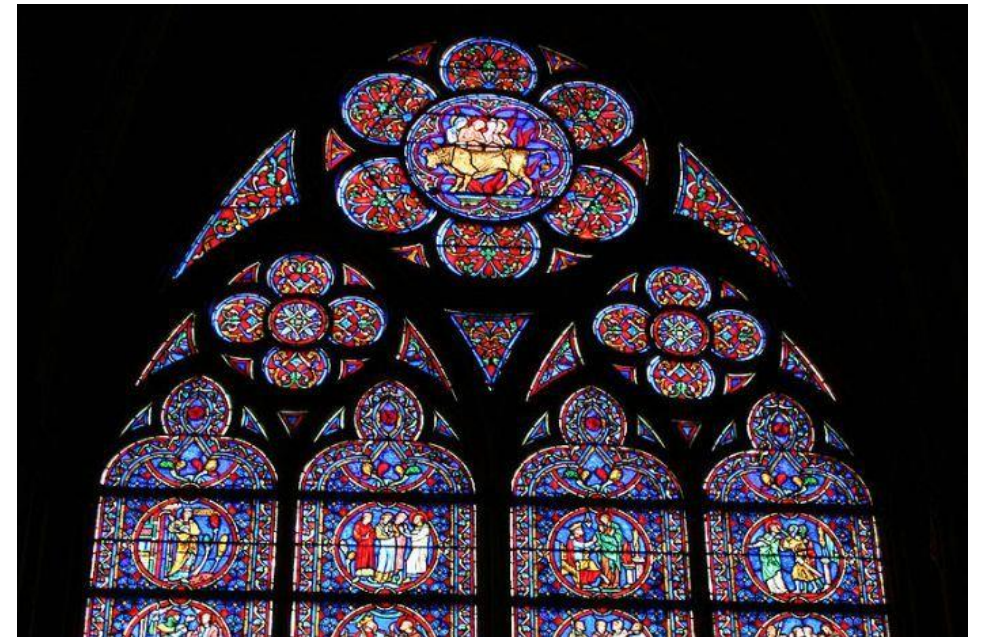
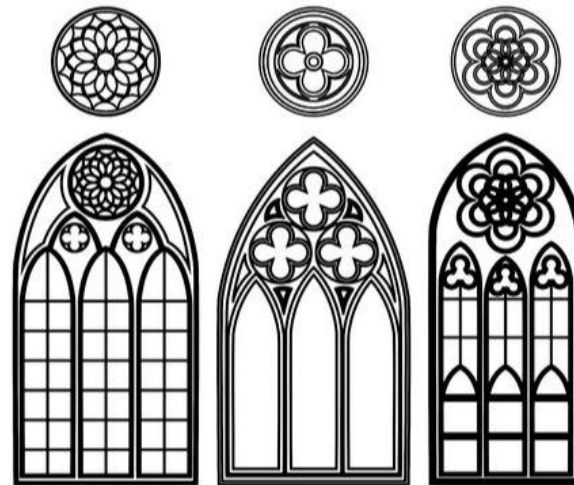
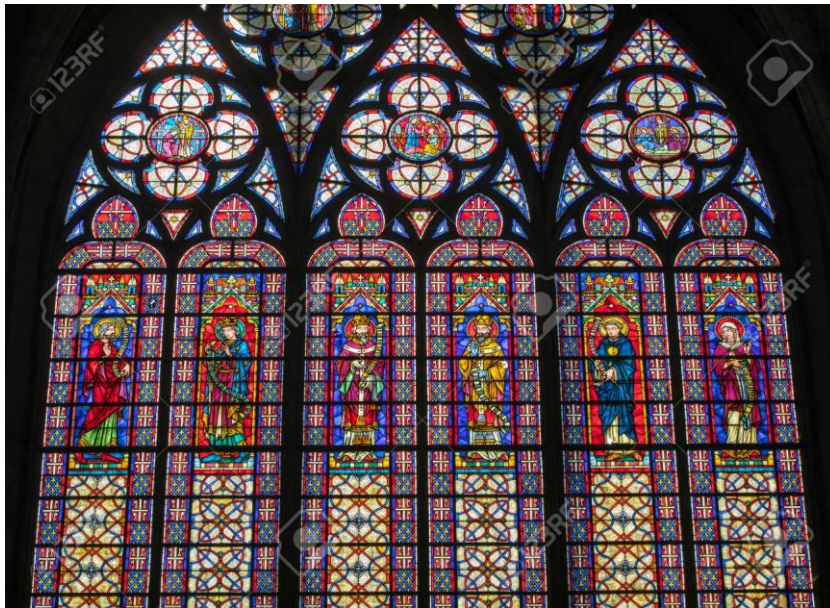

Gargoyles

- In addition to religious figures, many Gothic cathedrals are heavily ornamented with strange, leering creatures.
- These gargoyles are not merely decorative.
- Originally, the sculptures were waterspouts to protect the foundation from rain.
- Since most people in Medieval days could not read, the carvings took on the important role of illustrating lessons from the from the scriptures



Notre dame cathedral



Notre dame cathedral



Notre dame cathedral

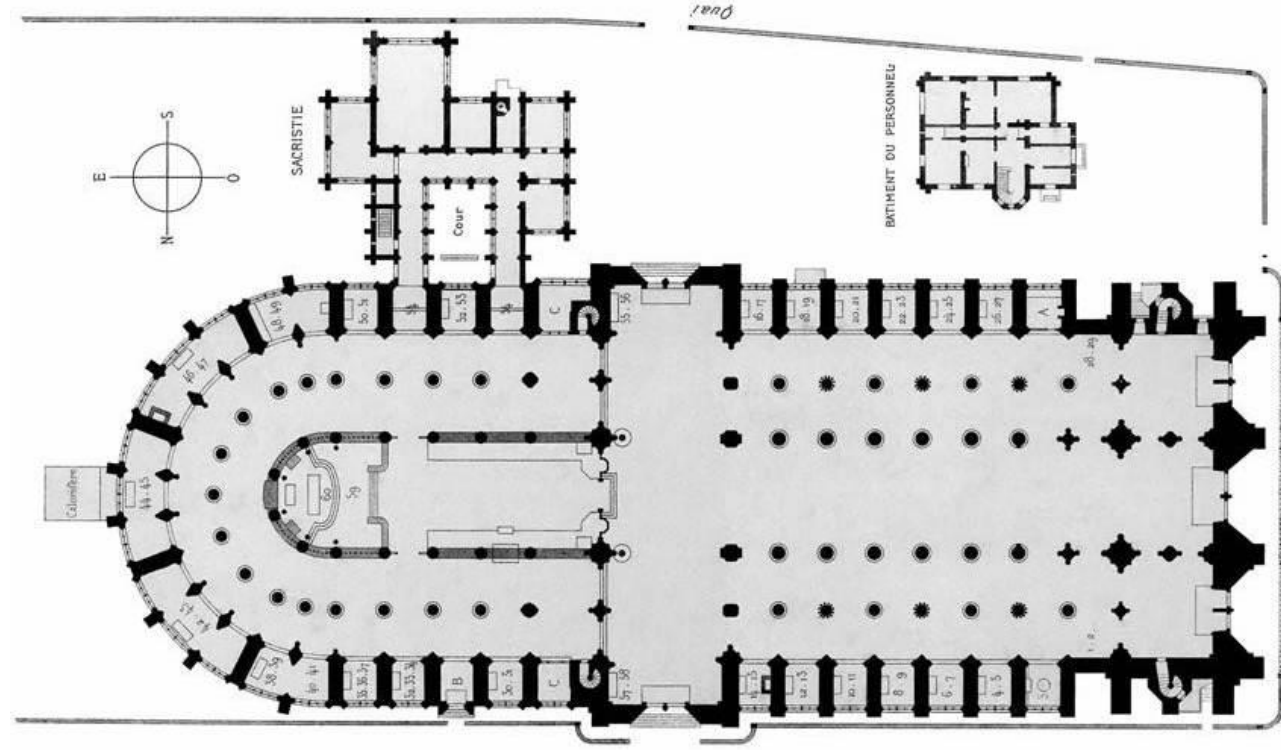

CHŒUR (côté nord)

- 3a.3b... Chapelle St Martin
 - 3c.3d... St Ferdinand
 - 3e.3f... St Germain
 - 3g.3h... St Louis
 - 3i.3j... St Marcel
- Chevet

- 4... Chapelle ND des sept douleurs

CHŒUR (côté sud)

- 16.17... Chapelle St Georges
- 18.19... St Guillaume
- 20.21... St Madeleine
- 22.23... St Denis
- 24... Passage de la Sacristie

- B... Passage de la Porte-Rouge

C... Débaras

5a... Sanctuaire

5b... id. de l'auel

5c... id. de l'auel

5d... id. de l'auel

5e... id. de l'auel

5f... id. de l'auel

5g... id. de l'auel

5h... id. de l'auel

NEF (côté nord)

- 1.2... Litaines de la Vierge
- 3... Chapelle des fonts bapt.
- 4.5... St Charles
- 6.7... de la S^{te} Enfance
- 8.9... St Vincent de Paul
- 10.11... St François Xavier
- 12.13... St Landry
- 14.15... St Otilille

NEF (côté sud)

- 16.17... Chapelle du Sacré Cœur
- 18.19... St Anne
- 20.21... St Pierre
- 22.23... St Joseph
- 24.25... St Geneviève
- 26.27... des faces de l'orgue
- 28.29... Christ (aurore)

A... Chambre du Prédicateur

PLATE 1a

Plan de Notre Dame de Paris
Plan of Notre Dame of Paris

Notre dame cathedral



Notre dame cathedral



Notre dame cathedral



Duomo-di-Milano Chathedral

* Cathedral Architecture

